

**3**  
BED

# A Stunning Victorian House - No Ongoing Chain

34, Norman Road, Newhaven, BN9 9LJ



Price £350,000

Freehold

**phillipmann**  
we do more

[www.phillipmann.com](http://www.phillipmann.com)

34 Norman Road, BN9 9LJ

Approximate Gross Internal Floor Area = 126.16 sq m / 1358 sq ft

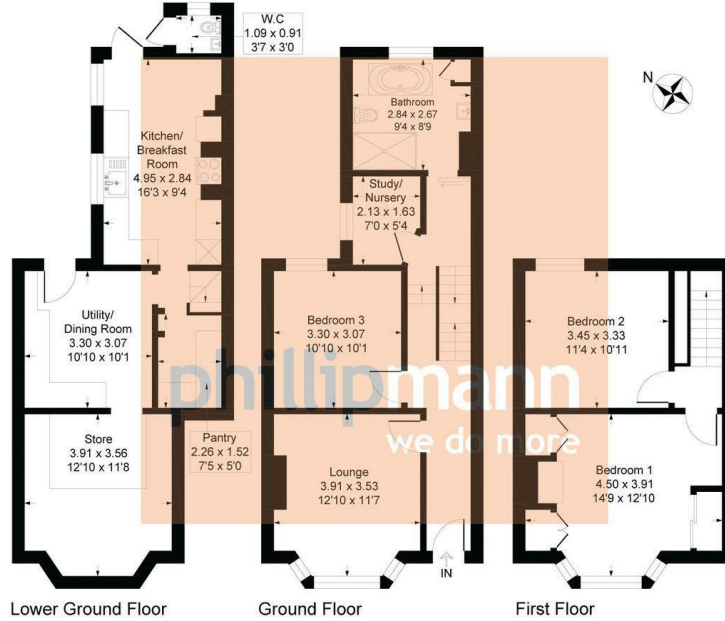

Illustration for identification purposes only, measurements are approximate, not to scale

inbrief...

Beautifully reimagined and full of character, this elegant period home in Newhaven offers a superb blend of timeless charm and stylish modern living. Fully refurbished throughout, the property is ready to move straight into, with new gas central heating and boiler (2021), full electrical rewiring, Victorian cast iron radiators, Farrow & Ball paintwork, original floorboards, natural Fibre carpets, exposed fireplaces and a cosy wood burner adding warmth and atmosphere.

At the heart of the home is a stunning kitchen, newly fitted in 2022, featuring baked earth terracotta floor tiles, solid walnut worktops, instant hot water tap, dishwasher, industrial-style fittings, exposed scaffold shelving and a practical pantry. The luxurious bathroom, also completed in 2022, is equally impressive with Heritage fittings, a rolled top freestanding bath, walk-in shower, built-in cupboard, olive green brick tiles and striking Emma Shipley wallpaper.

A beautifully designed utility/diner room, created in 2025, adds further versatility, complete with rustic built-in cabinetry, scaffold worktops, underfloor heating and subtle mood lighting. Upstairs, the generous main bedroom boasts a lovely bay window and bespoke wardrobes with full-length mirror, while bedrooms two and three are both spacious doubles, alongside a useful study or nursery.

There is exceptional storage with two lofts and a basement room, with the main loft already boarded and wired for potential conversion (subject to consent). Set within a friendly street, this wonderful home also benefits from excellent links to Brighton, London and the Port of Newhaven ferry to Dieppe.



Energy Rating D

Council Tax C

moreinfo...



Phillip Mann Newhaven Office  
16 Bridge Street, Newhaven, BN9 9PJ  
01273 517517

To see more details on this & all our homes go to [www.phillipmann.com](http://www.phillipmann.com)